



INSTALLATION INSTRUCTIONS
COLD AIR INTAKE KIT
2007 DODGE NITRO 3.7L V6
PART NUMBER 77060080

Bill of Materials for Part Number 77060080

Part Number	Description	Quantity
2-82181M	Inlet pipe	1
K6857148	Instructions	1
77070013	Air Filter Assembly 3.00 9" Element Dry	1
559999	M6 Washer	4
1-3028	1/4 Washer	1
1-2072	1/4-20 x 1 3/4 Bolt	1
1-2074	1/4-20 Nylock Nut	1
1-2073	1/4-20 Nut	1
2-670	Spacer	1
103-BLO-4820N	#48 Hose Clamp	1
103-BLO-4420N	#44 Hose Clamp	1
103-BLO-5220N	#52 Hose Clamp	1
784634	Grommet	1
99024.032	Hose Clamp 1"	1
8-119	Gasket Sponge	12
8-119	Gasket Sponge	5
1228599	Rubber Mount 1"	1
444.460.04	M6 Nut	3
20-8218	Heat Shield	1
5-273	2.75/3.00 Adapter	1



INSTALLATION INSTRUCTIONS
COLD AIR INTAKE KIT
2007 DODGE NITRO 3.7L V6
PART NUMBER 77060080

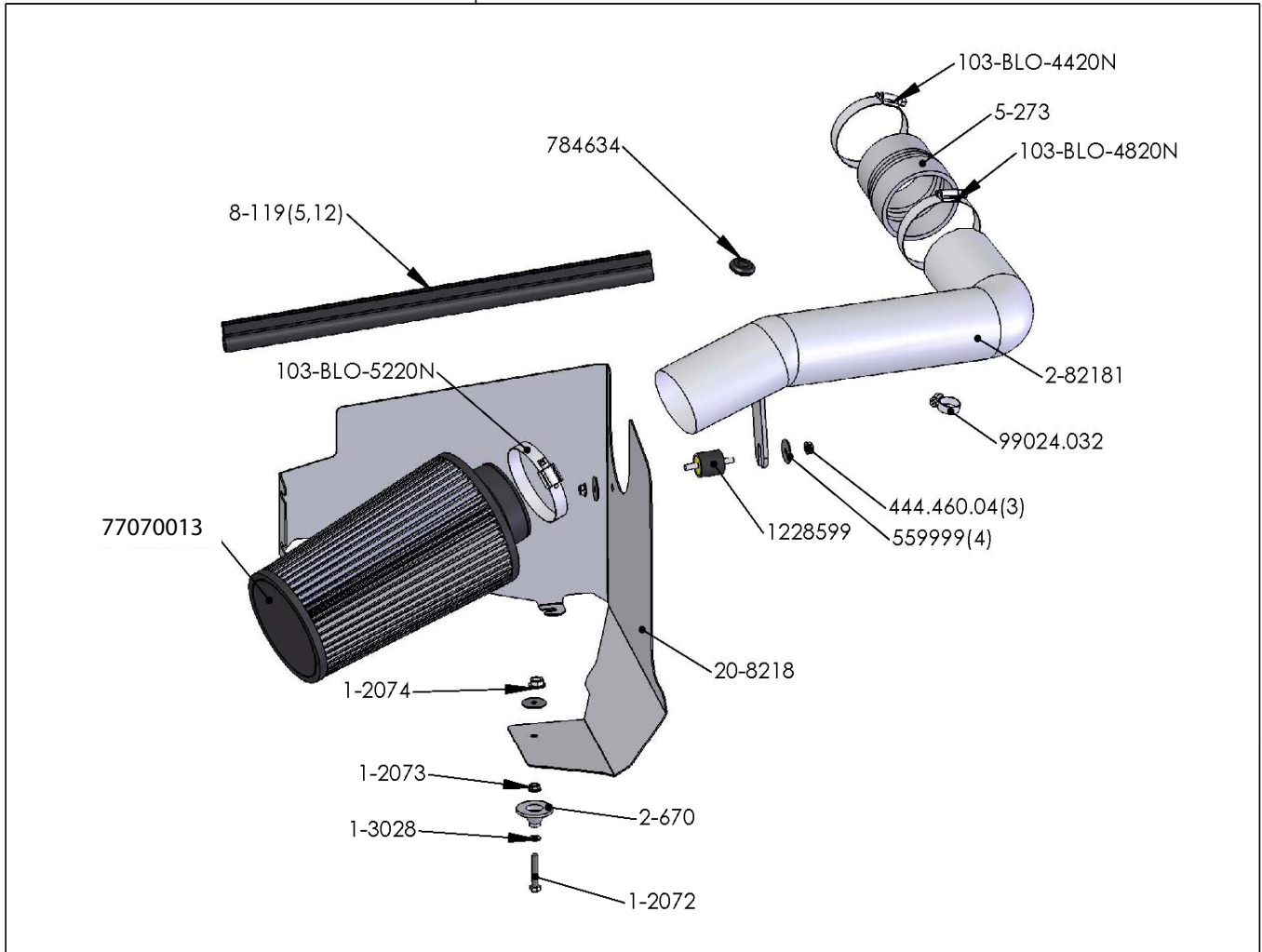

IMPORTANT:

This kit includes a Dry Filter. **DO NOT APPLY ANY OIL TO THIS FILTER!** See step 5 for cleaning instructions.

Read and understand these instructions **BEFORE** attempting to install this product.

1) Getting Started

- a) Make sure vehicle is parked on a level surface.
- b) Set parking brake.
- c) If engine has run with in the past two hours let it cool down.
- d) Disconnect negative battery terminal.



INSTALLATION INSTRUCTIONS
COLD AIR INTAKE KIT
2007 DODGE NITRO 3.7L V6
PART NUMBER 77060080

2) Removal of the stock air intake system

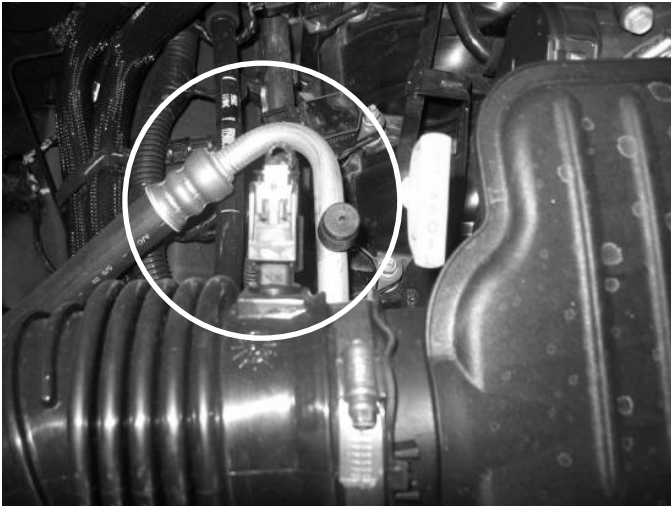

a) Disconnect the Inlet Air Temperature (IAT) Sensor connector. Push up the on the release (red) and depress the connector (black).



b) Loosen hose clamp at the throttle body.



c) Remove the PCV breather tube from the air box. Remove air box and inlet tube.



INSTALLATION INSTRUCTIONS
COLD AIR INTAKE KIT
2007 DODGE NITRO 3.7L V6
PART NUMBER 77060080

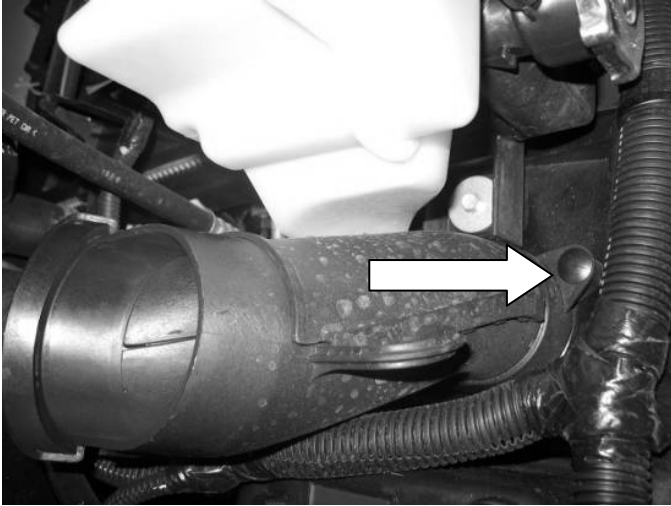

d) Remove air duct by removing push-in tab.

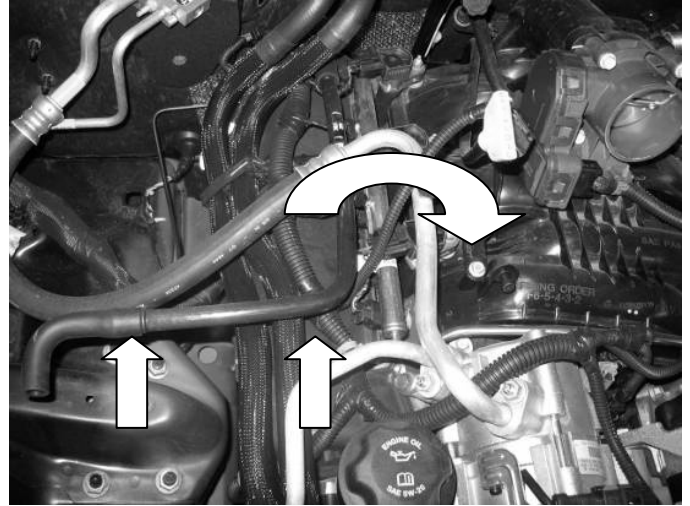

e) The breather hose will need to be rotated, so that the outlet is underneath the throttle body.

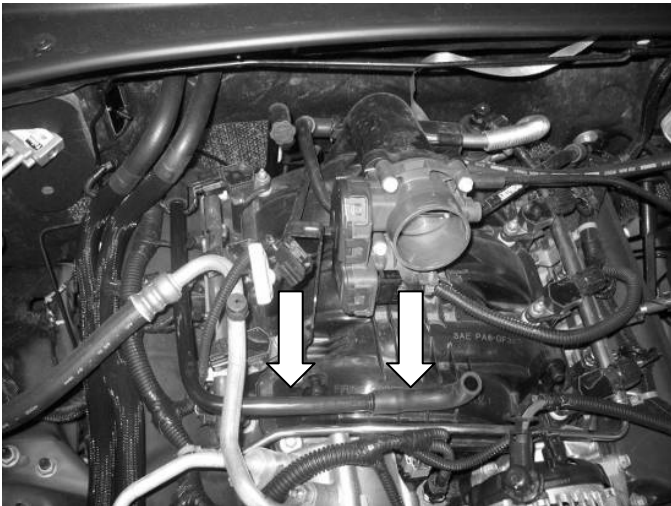

f) The breather hose should sit as shown. The outlet should sit vertical.



INSTALLATION INSTRUCTIONS
COLD AIR INTAKE KIT
2007 DODGE NITRO 3.7L V6
PART NUMBER 77060080

3) Installation of the **MOPAR Cold Air Intake System**

- a) When installing the MOPAR Cold Air Intake System, DO NOT completely tighten the hose clamps or mounting tab hardware until instructed to do so later in these instructions.

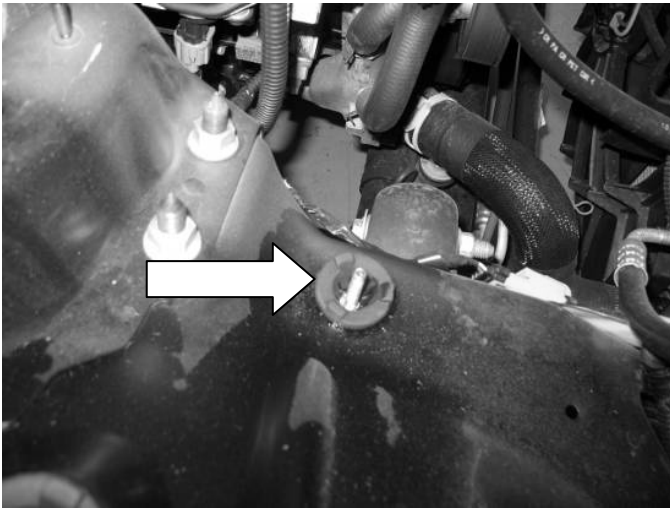

b) Insert the 1/4-20 bolt and 1/4" washer from underneath the grommet through the fender well.



c) Secure the 1/4-20 bolt and washer with the 1/4-20 nut. Tighten.

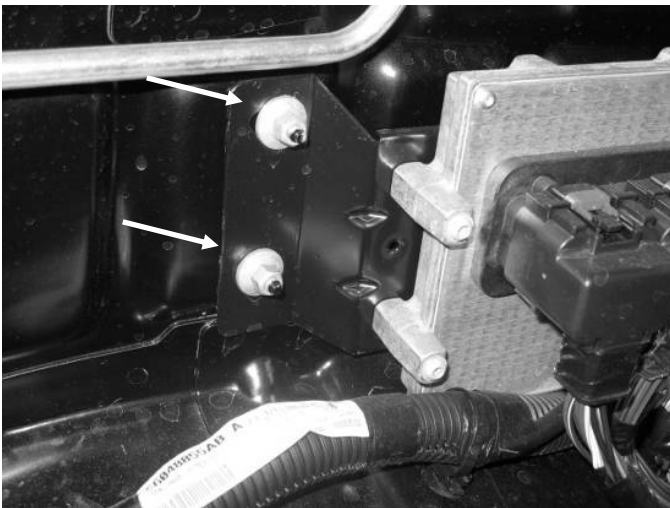

d) Loosen and remove the mounting bracket nuts. These nuts will be reused.

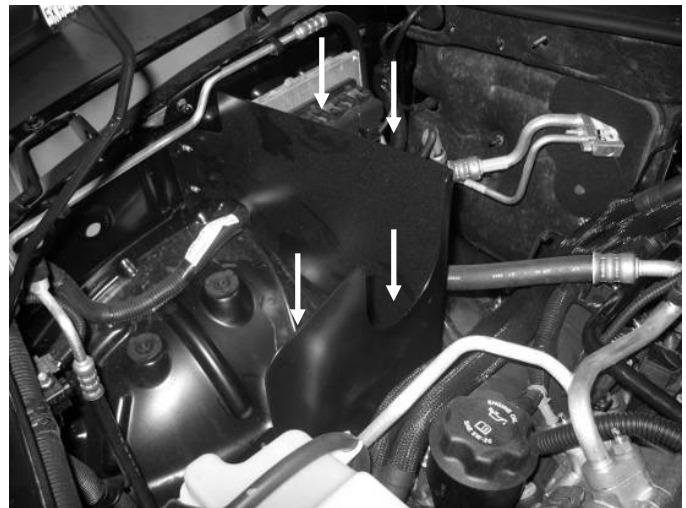

e) Insert the heat shield as shown. Align the heat shield to the studs in previous step. The bottom of the heat shield should align with the stud from step 3c.



INSTALLATION INSTRUCTIONS
COLD AIR INTAKE KIT
2007 DODGE NITRO 3.7L V6
PART NUMBER 77060080

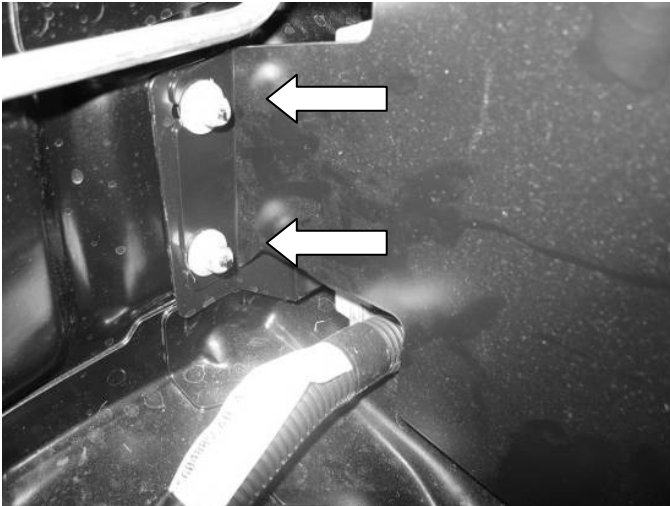

f) Secure the heat shield with the nuts from 3d.

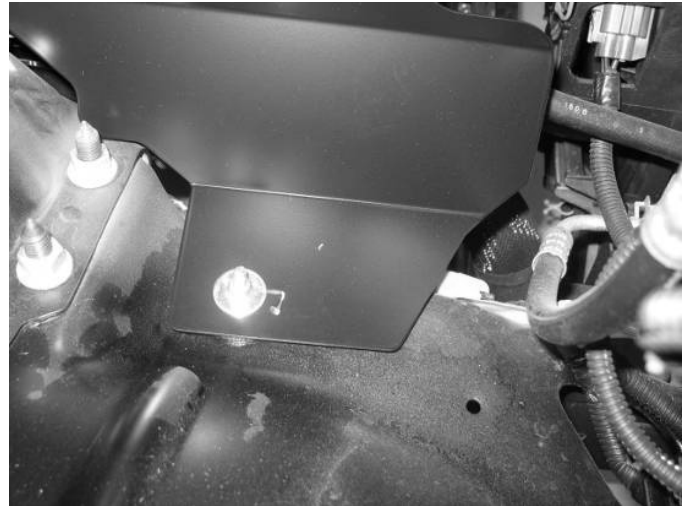

g) Secure the bottom of the heat shield with the fender washer and nylock nut.

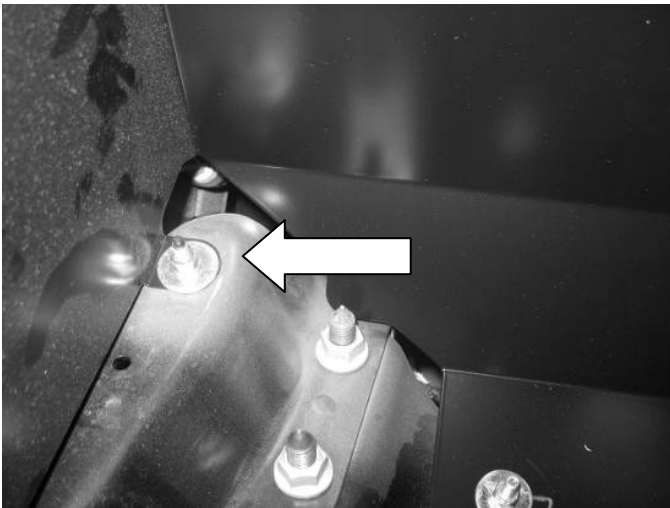

h) Secure the heat shield tab with the fender washer and M6 nut.

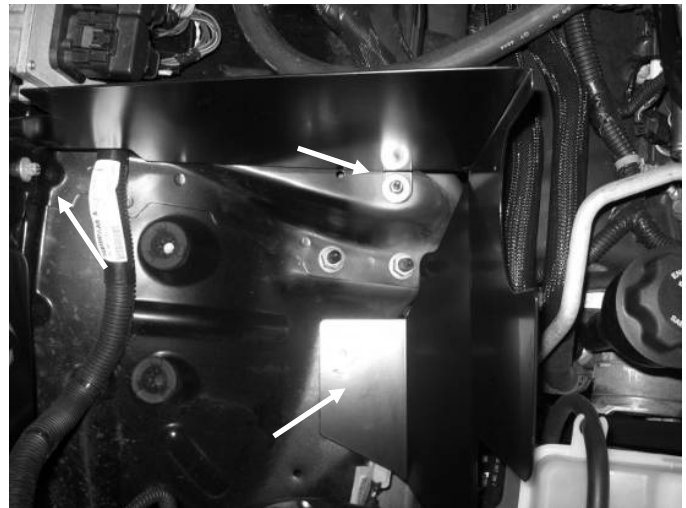

i) Check clearance around the body and the heat shield. Tighten all mounting points.



INSTALLATION INSTRUCTIONS
COLD AIR INTAKE KIT
2007 DODGE NITRO 3.7L V6
PART NUMBER 77060080



j) Attach the reducer coupler to the throttle body and secure with #44 and #48 hose clamps.

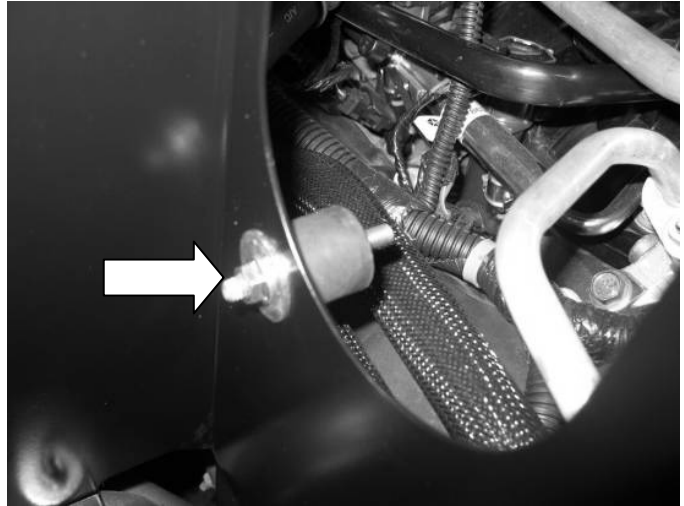

k) Insert the rubber mount into the heat shield and tighten with fender washer and M6 nut.

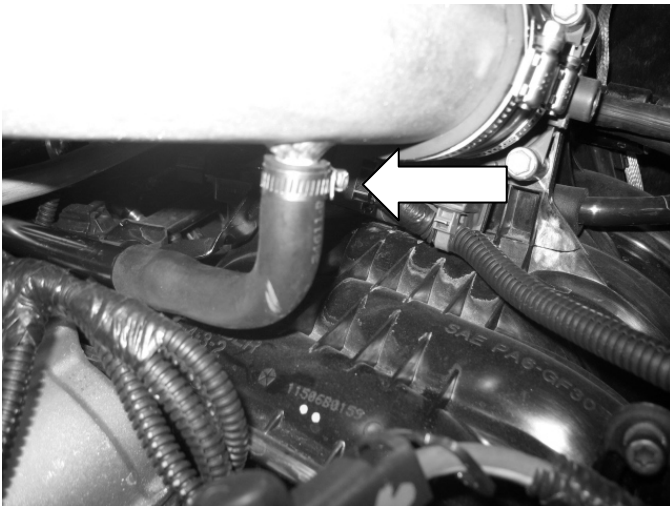

l) Attach the breather hose to the inlet pipe and secure with 1" hose clamp.

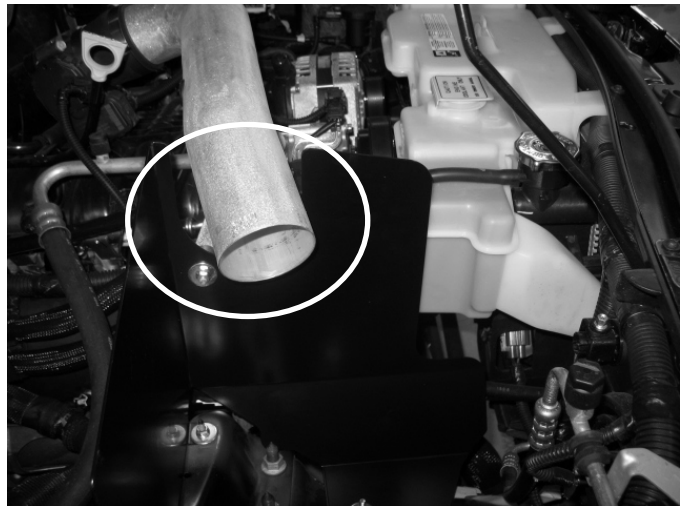

m) Check clearance around the inlet pipe and the heat shield.



INSTALLATION INSTRUCTIONS
COLD AIR INTAKE KIT
2007 DODGE NITRO 3.7L V6
PART NUMBER 77060080

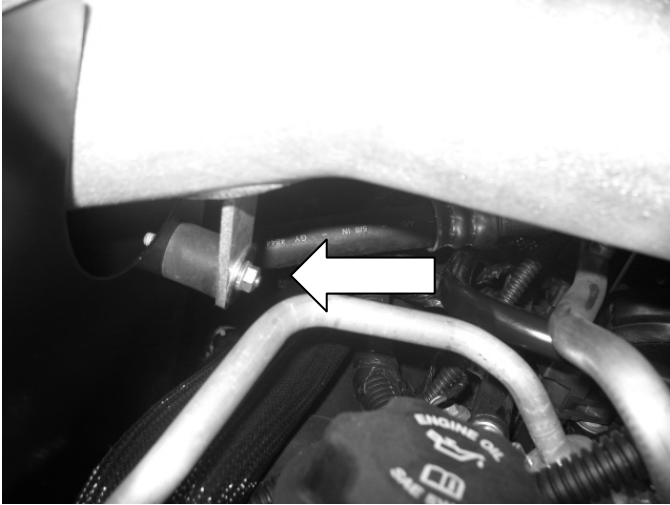

n) Secure the bracket with fender washer and M6 nut.



o) Install the grommet for the IAT sensor. Reinstall the IAT sensor and reconnect.



p) Attach the filter element and secure with #52 hose clamp.

4) Re-assemble the vehicle

- a) Position the filter for best fitment. Be sure that the filter, tube, or any other components do not contact any part of the vehicle.
- b) Tighten all hose clamps.
- c) Tighten the bolts and nuts on the mounting bracket.
- d) Inspect the engine bay for any loose tools and check that all fasteners that were moved or removed are tight.
- e) Reconnect the negative battery terminal.
- f) Start engine and perform a final inspection before driving the vehicle.



INSTALLATION INSTRUCTIONS
COLD AIR INTAKE KIT
2007 DODGE NITRO 3.7L V6
PART NUMBER 77060080

5) Dry Filter cleaning procedure

- Remove filter from intake pipe and set the filter clamp aside.
- Measure the length of the filter media.
- Fill a pail with warm clean water to the depth determined in Step b. Add a mild household detergent to the water.
- Without allowing the solution to flow into the filter neck, submerge the filter into the water and let it soak for 10 minutes. After soaking, rotate the filter back and forth to agitate the water and knock off dirt.
- Empty the bucket of dirty water. Repeat steps C and D.
- Refill the pail with clean warm water and rinse by rotating the filter as in step D. The water should be clear with no signs of dirt in the pail.
- Allow the filter to air dry. **DO NOT APPLY ANY OIL TO THIS FILTER.** Re-install the filter on the intake system once it is dry.

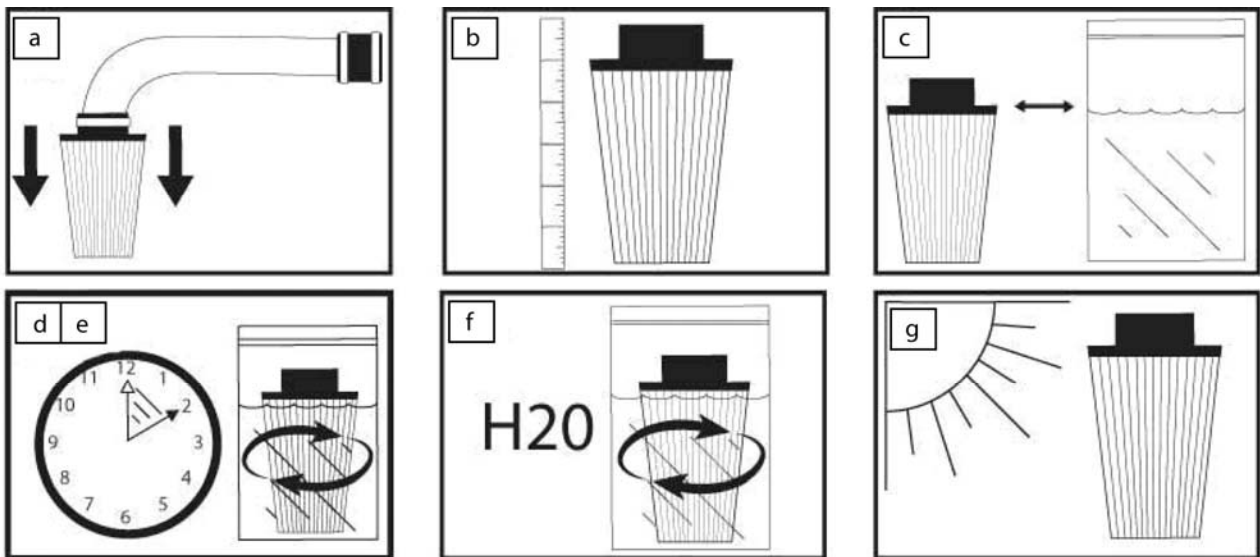

For technical assistance regarding MOPAR Cold Air Intake Systems, please call toll-free 1-888-528-HEMI (528-4364).